

QUESTO DISEGNO È DI PROPRIETÀ DELLA DITTA FIORTECH E NON PUÒ ESSERE USATO, E/O CEDUTO A TERZI SENZA IL PERMESSO SCRITTO DELLA FIORTECH
 THIS DRAWING IS THE PROPERTY OF FIORTECH FACTORY AND IT CAN NOT BE USED, REPRODUCED AND OR LOANED TO THIRD PARTIES WITHOUT THE WRITTEN PERMISSION OF FIORTECH

CM-127-P-2x (XX) -1- (YY) - A/B/C

(XX) = N = number of contacts between 02 and 50

Put the desired dimensions for A, B and C in mm unit

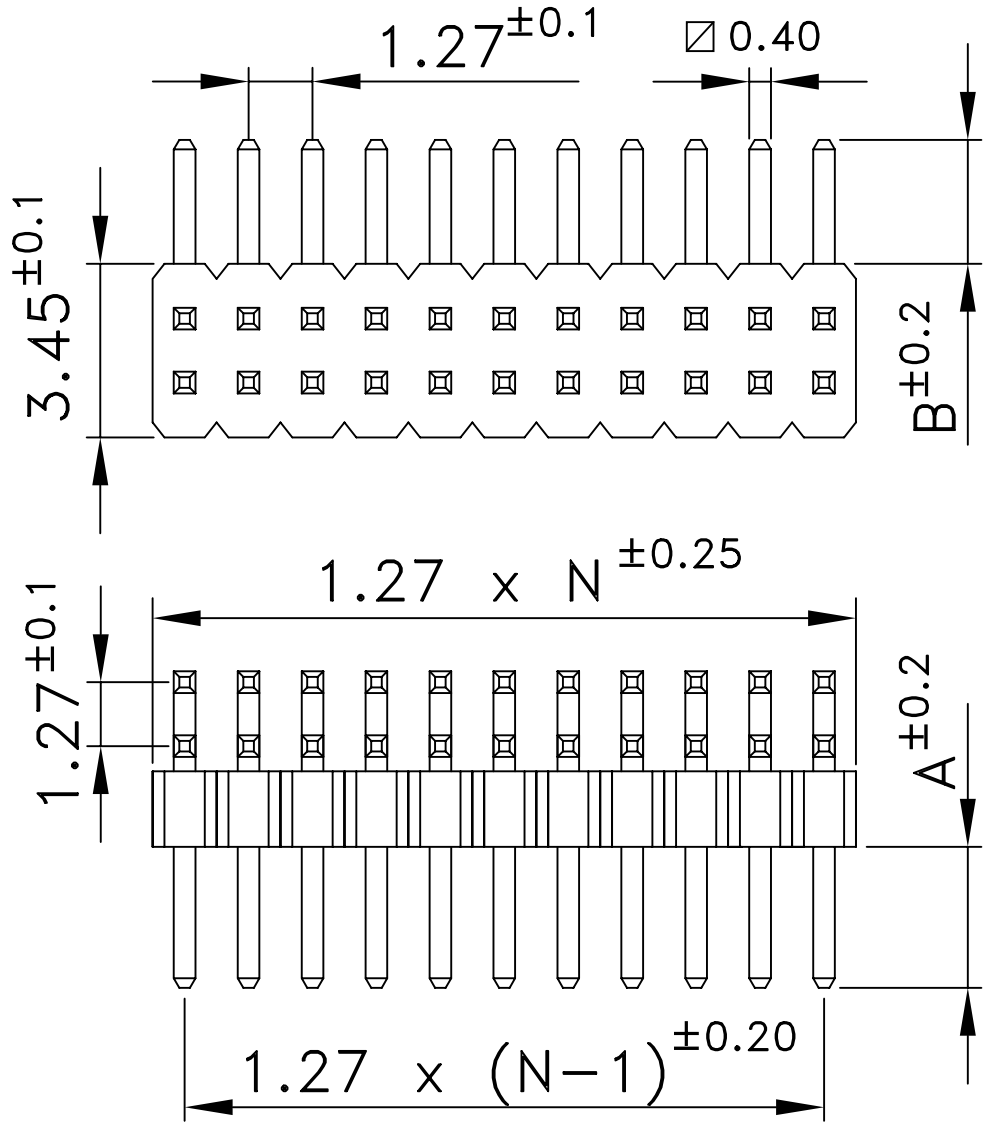

Plating:

- (YY) = FG = gold flash (standard)
- (YY) = G1 = gold 0.12μm
- (YY) = G2 = gold 0.25μm
- (YY) = G3 = gold 0.50μm
- (YY) = G4 = gold 0.75μm
- (YY) = TF = pure tin flash
- (YY) = T1 = pure tin 5μm
- (YY) = FS = selective gold flash
- (YY) = S1 = selective gold 0.12μm
- (YY) = S2 = selective gold 0.25μm
- (YY) = S3 = selective gold 0.50μm
- (YY) = S4 = selective gold 0.75μm

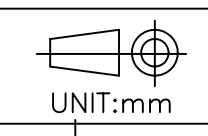

ELECTRICAL PROPERTIES

Current rate: 1 Ampère
 Insulation resistance: 5000MΩ min.
 Contact resistance: 10mΩ max.
 Dielectric Voltage: 500V AC for 1 minute

MECHANICAL PROPERTIES

Operating temperature: -40°C ± +105°C
 Peak temperature: 160° for 5+10 sec
 PCB recommended holes: ø0.65mm

INSULATOR HEIGHT AVAILABILITY (C)

1.0mm	C=1.5	pin	ø0.40
1.5mm	C=2.0	pin	ø0.40
1.7mm	C=2.2	pin	ø0.40
2.0mm	C=2.5	pin	ø0.40
2.5mm	C=3.0	pin	ø0.40

INDEX	DATE	MODIFICATION OCCURRED
-	-	-

TOLERANCES FOR FREE DIMENSIONS

ANGULAR VALUES	FROM 0.5 TO 3.0	FROM >3.0 TO 6.0	FROM >6.0 TO 10.0	FROM >10.0 TO 18.0	FROM >18.0 TO 30.0	FROM >30.0 TO 50.0	FROM >50.0 TO 80.0	FROM >80.0 TO 120.0	FROM >120.0 TO 180.0	FROM >180.0 TO 250.0	FROM >250.0 TO 315.0
±2°	±0.125	±0.150	±0.180	±0.215	±0.260	±0.310	±0.370	±0.435	±0.500	±0.575	±0.650

Material: Pin: copper alloy (standard: brass)
 Insulator: Nylon 6T (UL94V0)

Insulator height and pin section for C dimensions:

- C=1.5 (insulator height is 1.0mm and pin is ø0.40)
- C=2.0 (insulator height is 1.5mm and pin is ø0.40)
- C=2.2 (insulator height is 1.7mm and pin is ø0.40)
- C=2.5 (insulator height is 2.0mm and pin is ø0.40)
- C=3.0 (insulator height is 2.5mm and pin is ø0.40)

Notes:

VISA Scale

Date of creation: 10-03-06

Designer: Chiappini R.

Part number: CM-127-P-2x (XX) -1- (YY) - A/B/C

Drawing number: _____

Index: _____

File: _____

Description: Double row right angle male connector pitch 1.27mm

